

SPL-M/D2R + SO-EVO

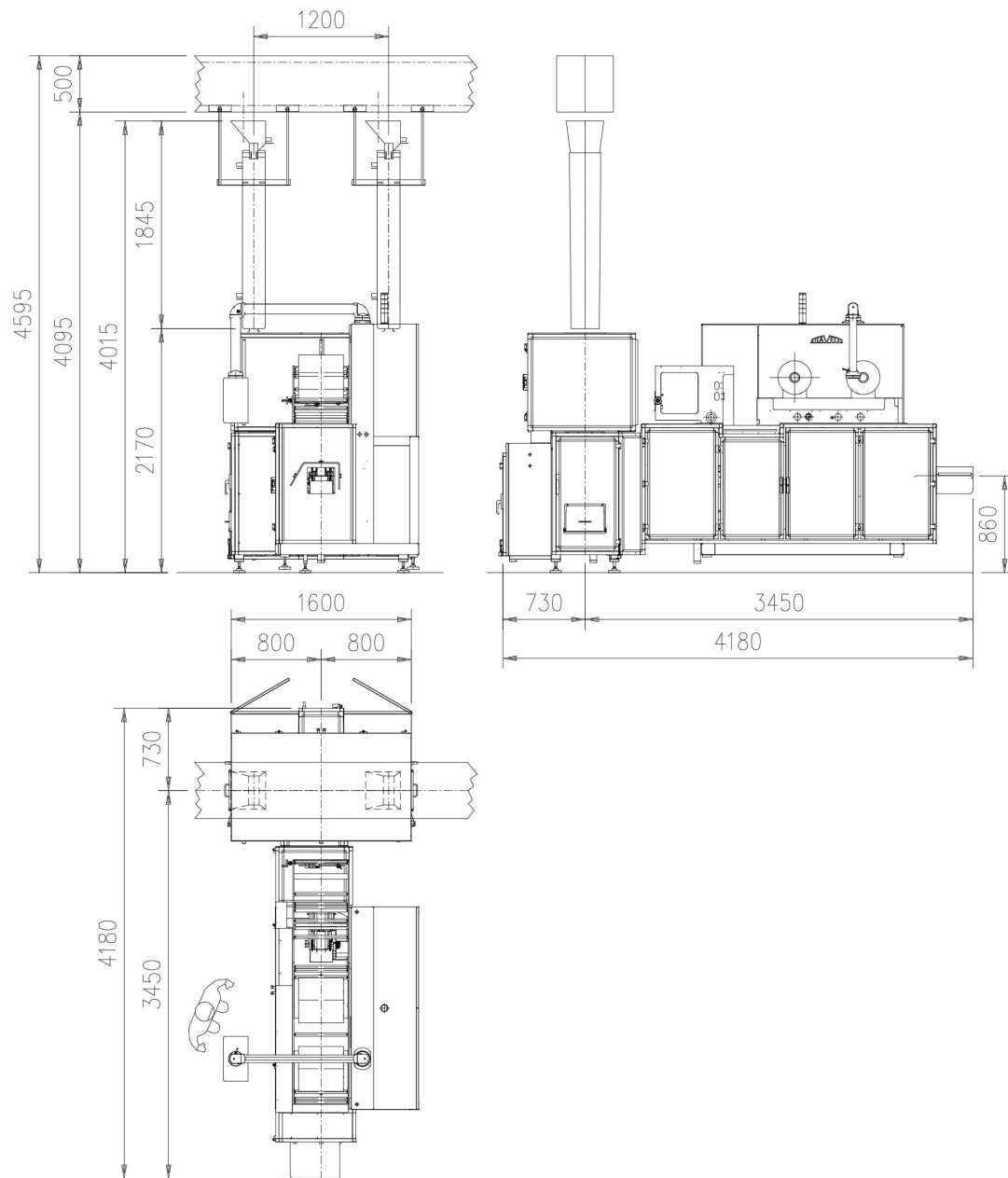

Products:

Round shapes: diameter from 0,9 to 4,0 mm (plain or hollow) - Length: 240 - 260 mm

Rectangular shapes: maximum length.

3,5 mm - width 1 mm

Weighing range: from 200 to 1000 gr

Bags flat size:

Width: from 72 to 160 mm

Length: from 200 to 350 mm

Film size:

Maximum Length : 400 mm

Maximum diameter: 350 mm

Approx. consumptions:

Absorbed power: 16 kW

Compressed air: 100 NI/ min at 6 BAR